

ASSEMBLY INSTRUCTIONS

SUMMIT

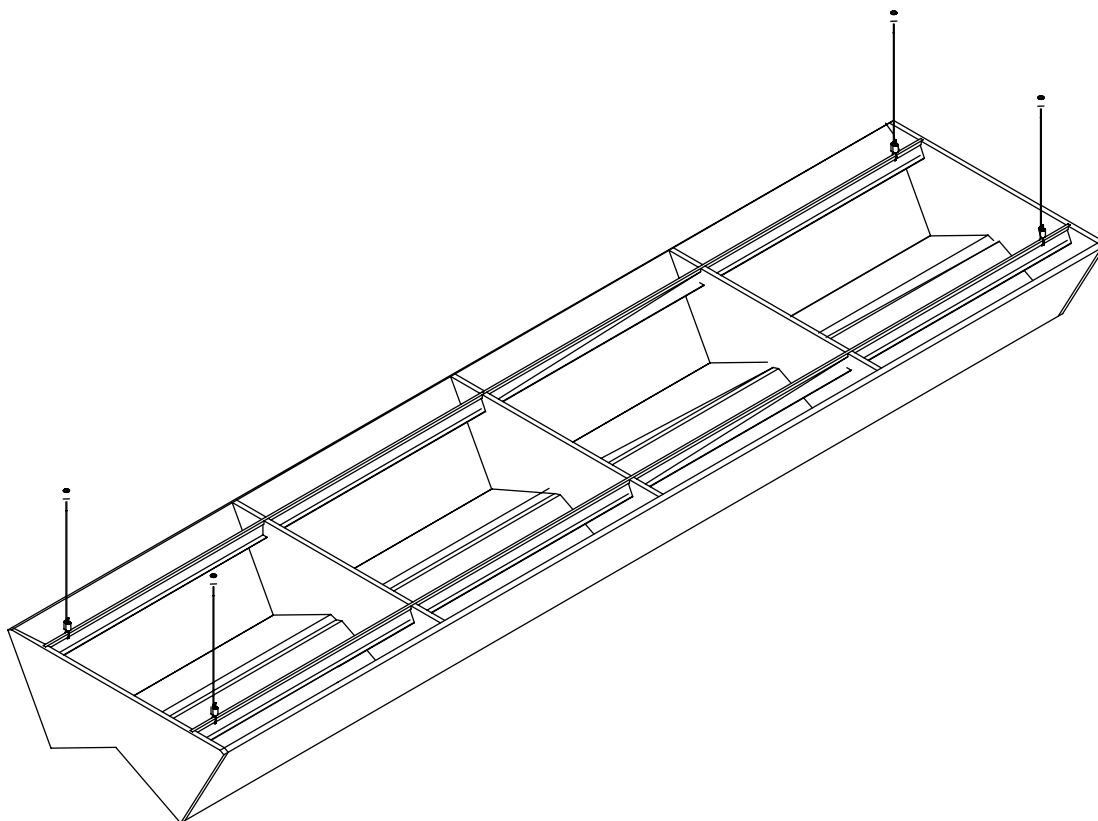

INSTALLATION HARDWARE

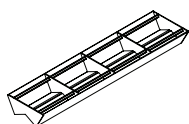

SUMMIT BAFFLE



BRASS LOCATOR



GRIPPER



TOP CAP
(4M CABLE INCLUDED)

*Images reflect typical hardware options. Please refer to packing list for items & quantities specific to your order

Thank you for your order!

For questions or concerns regarding your order or installation, please contact customer service at 1-844-441-1122 or via email at sales@ayrsonics.com (Canada) or info@usa.ayrsonics.com (USA).

ASSEMBLY INSTRUCTIONS

WORK ZONE DIVIDER

UPPER SUSPENSION HOUSING

- 1 Locate available suspension points on ceiling in relation to Summit Cloud suspension locations.
- 2 Mount brass locators securely onto ceiling with substrate appropriate fasteners (not included).
For ACT applications, wood backers needed.
- 3 Thread top caps onto brass locator by hand only.
- 4 Thread suspended cable through one side of cable gripper, through t-bar, and back through opposite side of cable gripper (Depress top/bottom nozzles to allow cable insertion; release to lock).
- 5 Level Summit Cloud using cable grippers and trim excess cable.

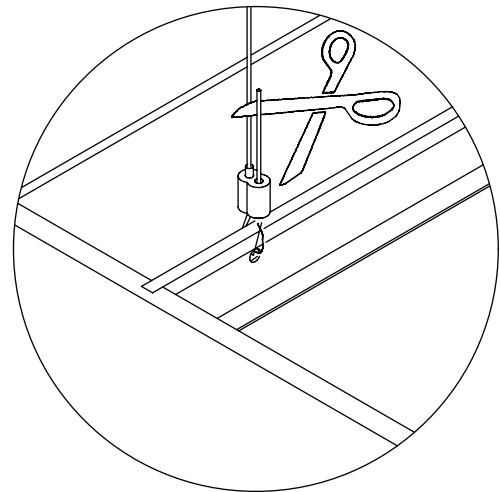
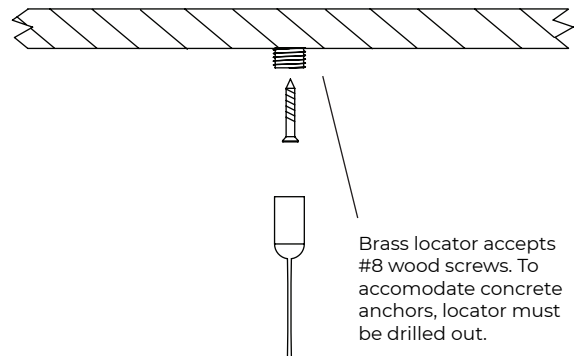

RECOMMENDED TOOLS

Drill - Level - Laser - Tape Measure - Allen Key

Thank you for your order!

For questions or concerns regarding your order or installation, please contact customer service at 1-844-441-1122 or via email at sales@ayrsonics.com (Canada) or info@usa.ayrsonics.com (USA).